

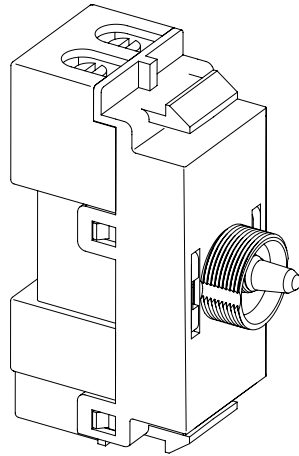

ELECTRICITY

Intermediate Toggle Module / 3 Way / 10A
GZTM-013292



TECHNICAL SPECIFICATION

3 Way Switch / Intermediate Switch
Rated at 10A 220 - 250VAC

IMPORTANT!

This product must be installed by a qualified professional. Turn off the power at the breaker prior to installing this product.

WARRANTY INFORMATION

The Warranty Period of Two (2) years from the date of the original purchase.

BUSTERANDPUNCH.COM
L0229



RECYCLING ELECTRICAL PRODUCTS

Buster + Punch encourages all of its customers to make note of this symbol and avoid putting any waste electrical goods in your domestic waste bin or container. Please ensure you take your waste electrical goods to a suitable facility for disposal.

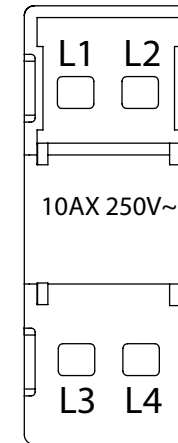

INTERMEDIATE SWITCH

1



**BEFORE COMMENCING WORK,
ISOLATE THE MAINS POWER
SUPPLY AND REMOVE THE
FUSE BOX OR SWITCH OFF
THE CIRCUIT BREAKER IN
CONSUMER UNIT.**



2 **ASSEMBLE TOGGLE ARM**

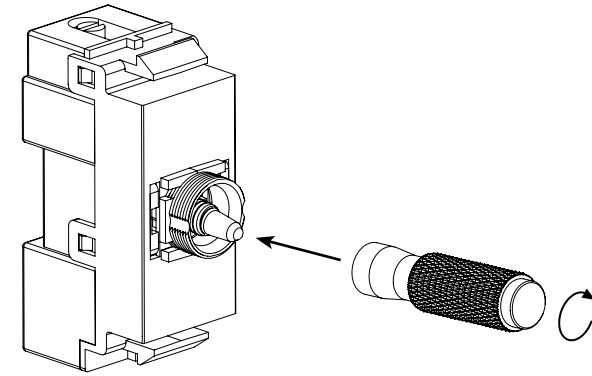

***NOTE:**

When tightening threaded parts be careful not to cross thread. We recommend pushing and rotating the part anticlockwise until you feel a click, then tighten clockwise finger tight.

3 **FIT TOGGLE TO PLATE WITH NUT**

Please ensure toggle nuts (A) are sufficiently tightened using the toggle nut tool (B). Please do not overtighten, or you may damage the threads.

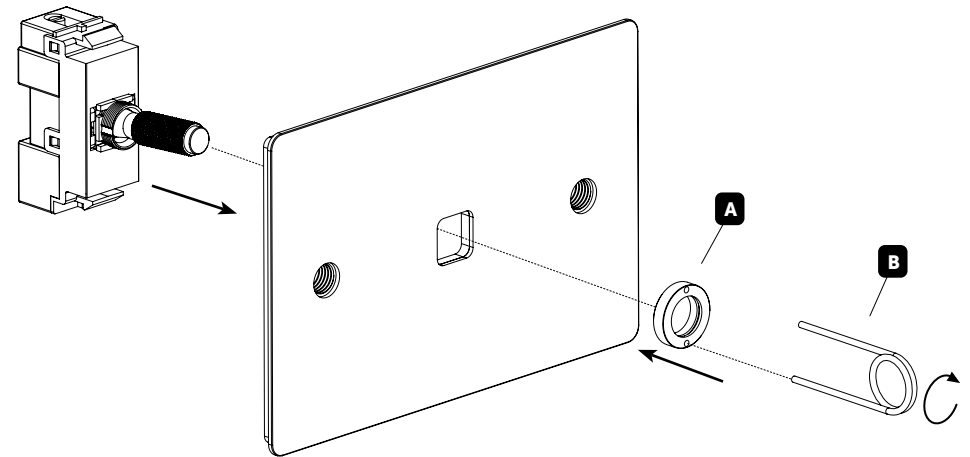

***NOTE:**

When tightening threaded parts be careful not to cross thread. We recommend pushing and rotating the part anticlockwise until you feel a click, then tighten clockwise finger tight.

4 HOW TO SWITCH LIGHTS FROM 3 OR MORE LOCATIONS USING BUSTER & PUNCH 2-WAY AND INTERMEDIATE SWITCHES.

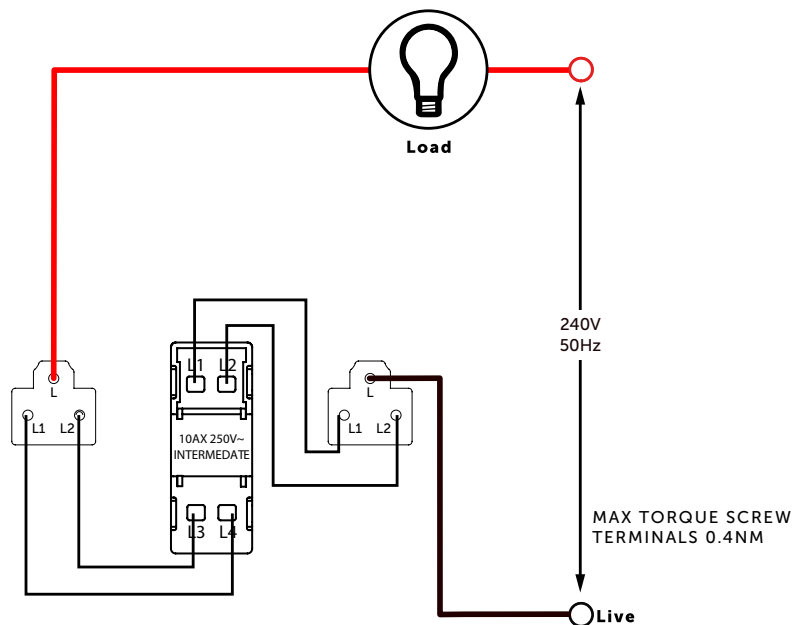

5 FIT TO WALL

Tighten plate to wall using screws (A)
Tighten coin cap (B) finger tight to isolator (C)
Tighten coin cap/isolator to plate using tool (D). Do not use a screwdriver
Please do not overtighten, or you may damage the threads.

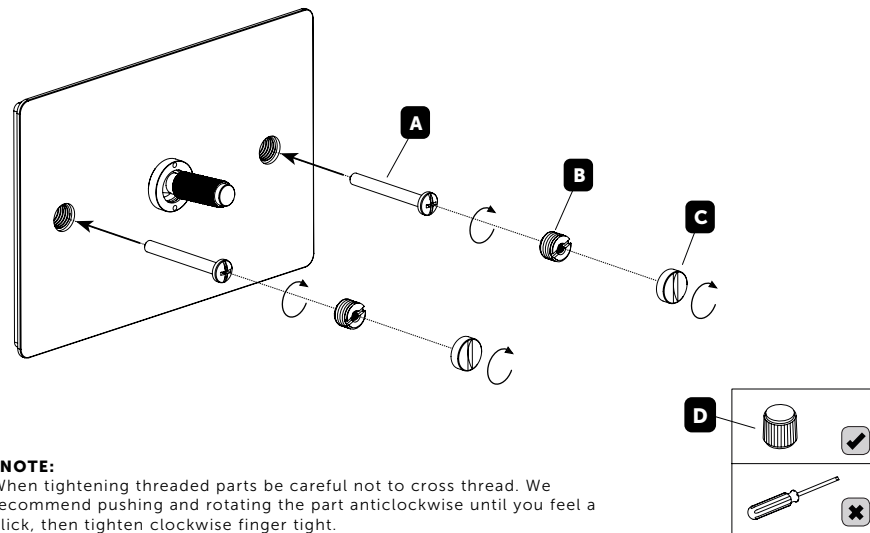

6 TURN POWER BACK ON.



[end. ORDINARY.]

