

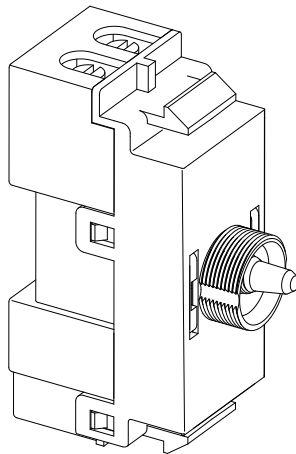

ELECTRICITY

Retractive Toggle Module / 2 Way / 10A
GZTM-013291
(Push to Make)



TECHNICAL SPECIFICATION

Retractive Switch (Push to Make)
10A 220 - 250VAC

IMPORTANT!

This product must be installed by a qualified professional. Turn off the power at the breaker prior to installing this product.

WARRANTY INFORMATION

The Warranty Period of Two (2) years from the date of the original purchase.

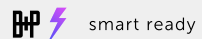

THIS IS A RETRACTIVE TOGGLE SWITCH, COMPATIBLE WITH INDUSTRY-STANDARD SMART CONTROL MODULES & DIMMERS WITH A RETRACTIVE INPUT

BUSTERANDPUNCH.COM / AU

L0228



RECYCLING ELECTRICAL PRODUCTS

Buster + Punch encourages all of its customers to make note of this symbol and avoid putting any waste electrical goods in your domestic waste bin or container. Please ensure you take your waste electrical goods to a suitable facility for disposal.

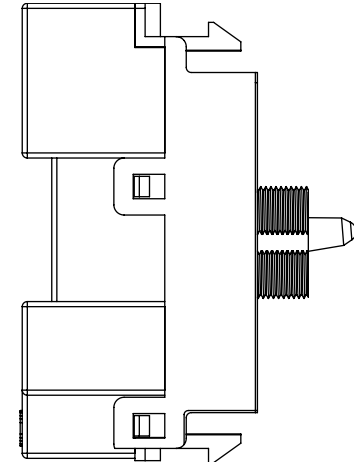
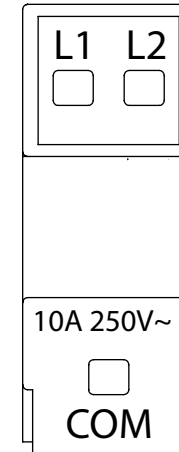

RETRACTIVE SWITCH

1



**BEFORE COMMENCING WORK,
ISOLATE THE MAINS POWER
SUPPLY AND REMOVE THE
FUSE BOX OR SWITCH OFF
THE CIRCUIT BREAKER IN
CONSUMER UNIT.**



2 ASSEMBLE TOGGLE ARM

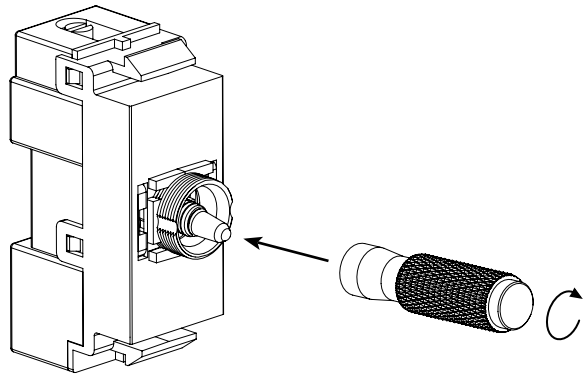

***NOTE:**

When tightening threaded parts be careful not to cross thread. We recommend pushing and rotating the part anticlockwise until you feel a click, then tighten clockwise finger tight.

3 FIT TOGGLE TO PLATE WITH NUT

Please ensure toggle nuts (A) are sufficiently tightened using the toggle nut tool (B). Please do not overtighten, or you may damage the threads.

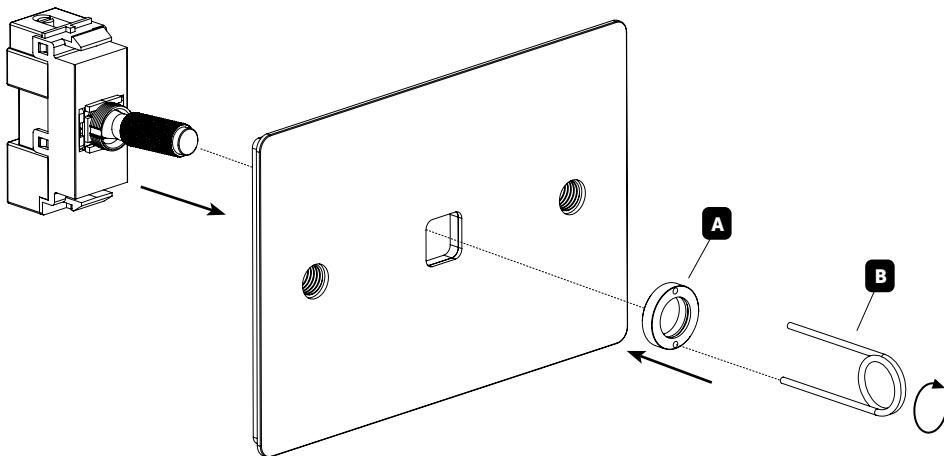

***NOTE:**

When tightening threaded parts be careful not to cross thread. We recommend pushing and rotating the part anticlockwise until you feel a click, then tighten clockwise finger tight.

4

Connect the wires as shown in appropriate wiring diagrams. Use green/yellow sleeving on earth conductors that are not insulated. Ensure terminals are properly tightened and no bare wire is visible. Push back unit into back box making sure conductors are not trapped.

NORMALLY ON

NORMALLY OFF

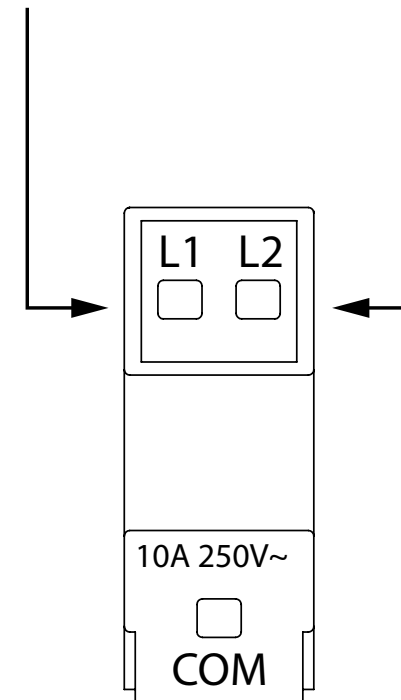

5 MULTIPLE LOCATION DIMMING

How to dim from multiple locations using Buster + Punch.

Retractive (push to make) Switch :

Press retractive dimmer to switch lights ON/OFF. Press and hold toggle to increase brightness, release and press and hold to decrease brightness.

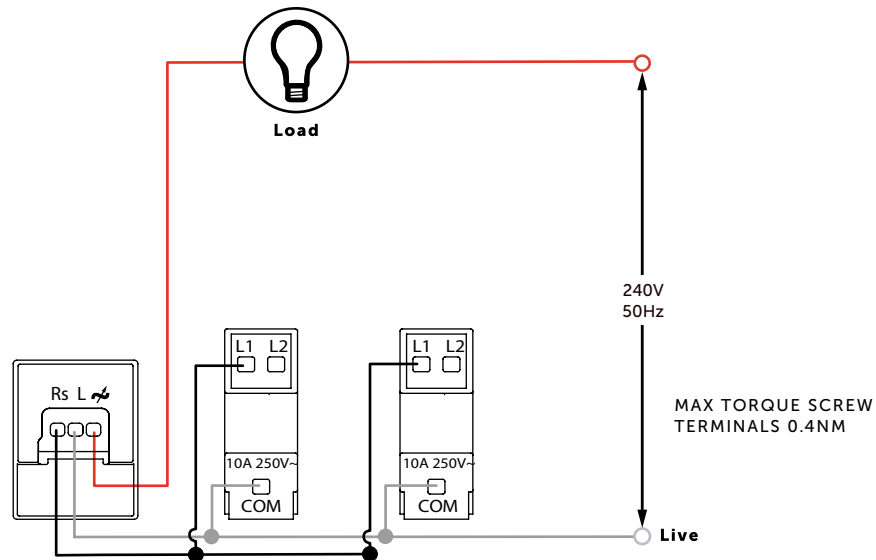

The Dimmer must always be connected to the LINE side of the load.

You can have up to 20 retractive dimmer switch or push switch connected to your dimmer to control from multiple locations.

6 FIT PLATE TO WALL

Tighten plate to wall using screws (A)
Tighten coin cap (B) finger tight to isolator (C)
Tighten coin cap/isolator to plate using tool (D). Do not use a screwdriver to plate using tool (D). Please do not overtighten, or you may damage the threads.

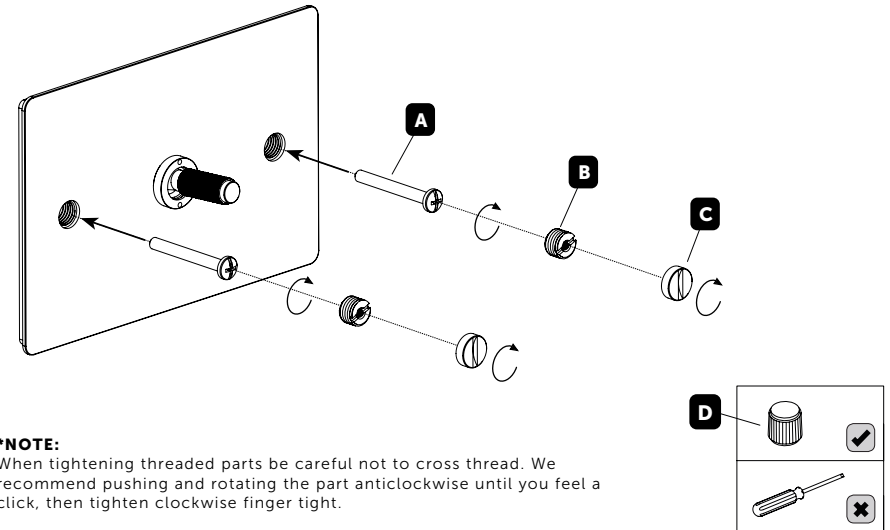

7 TURN POWER BACK ON.



[end. ORDINARY.]

